



OVERVIEW

A Miami Beach Masterpiece rises from behind a historic façade. Sunlight flashes off a translucent glass tower. Fine details create powerful sensations and timeless impressions. A limited-edition collection of 21 residences connect to the sand and the warm waters of the Atlantic Ocean.



RESIDENCES AND AMENITIES

Inspired by Excellence

L'Atelier is a concept whose time has come. Nowhere else does the glamour of South Florida, the exclusivity of Miami Beach, and the vision of the world's most creative minds come together so beautifully.

Residences

- Expansive Balconies with Panoramic Ocean and City Views
- 10 ft+ Ceiling Height in All Residences
- Outdoor Whirlpool Spa in each Residence
- Half-floor Residences
- Full-floor Residences
- Penthouse Residences

Amenities

- Concierge
- 24 hour Valet
- Private Beach Area
- Pool and Beach Attendant
- Oceanfront Infinity Edge Swimming Pool
- Upper Deck 70 ft Lap Pool
- Poolside Cabanas
- Pool Bar and BBQ Area
- Oceanfront Whirlpool Spa
- Hammock Garden
- Spa Facility and Treatment Room
- Sauna and Steam Room
- Beauty Salon
- Double Height State-of-the-Art Gym
- Library and Meeting Room



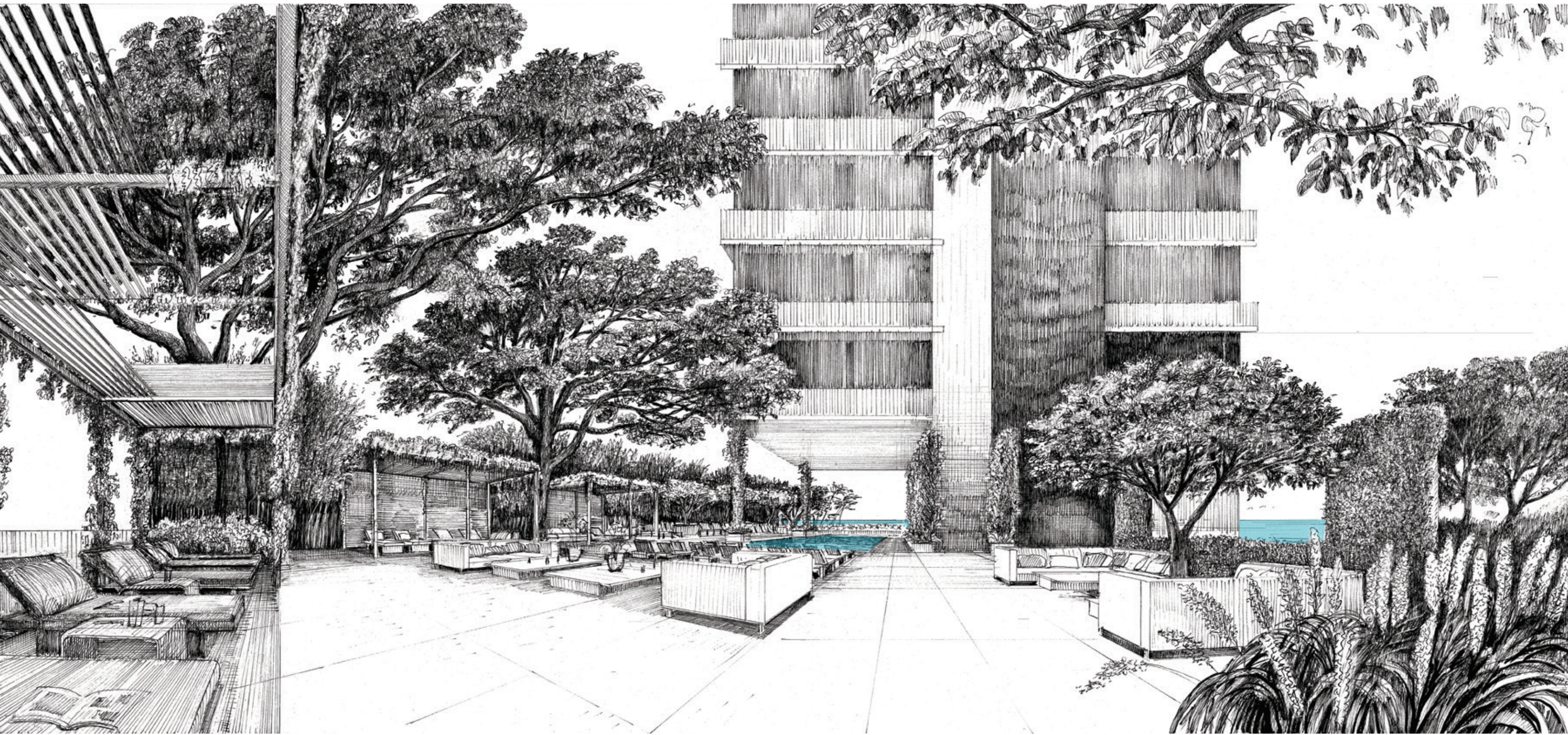



INTERIORS

Beautifully crafted
with exquisite finishes...
L' Atelier is a modern
work of art.





Fine details
Powerful sensations
Timeless impressions

VIEWS

Designed as complete flow-through residences, L' Atelier offers captivating vistas in every direction.

To the east, the gorgeous turquoise blues of the Atlantic blend seamlessly with the horizon. To the west, the emerald greens of the La Gorce Golf Course contrast with the skyline of downtown Miami. To the south, the historical Art Deco District and the towers of South Pointe shine. To the north, Allison Island, the architecture along Collins Avenue and the high-rises of Bal Harbour put the finishing touches on a location that is truly spectacular.



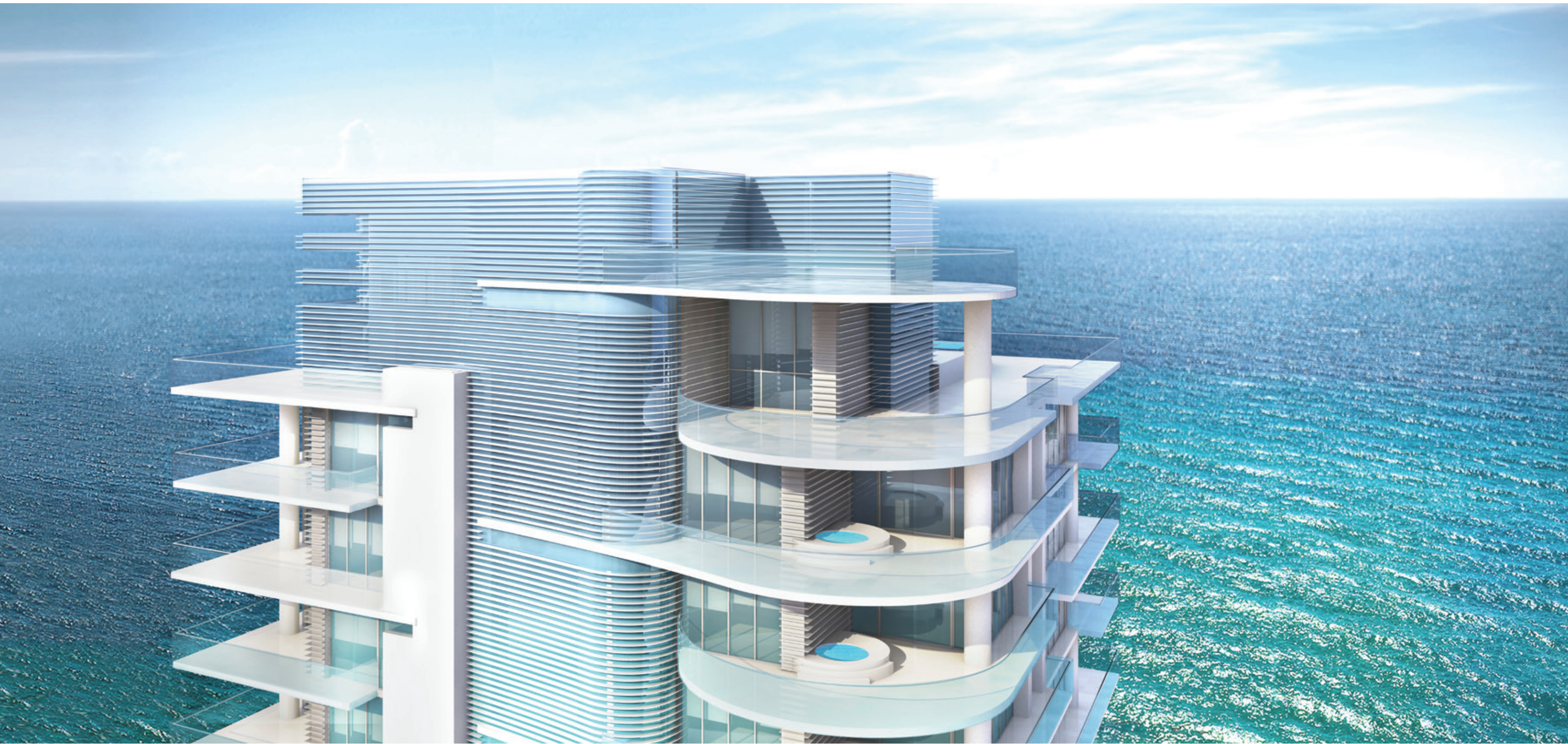

NEIGHBORHOOD

Begin each day with sunrises over the ocean. Savor a warm cup of coffee on your expansive balcony as nothing stands between you and your view. Then, venture downstairs for a walk along a quiet stretch of beachfront, free from the hustle and bustle of tourists and traffic.

Just outside the historic front facade, the many treats of Collins Avenue beckon. Sidewalk cafes offer a perfect spot for lunch while exploring fashion boutiques and other shops. Walk across the street to Indian Creek to board your yacht or charter one for the afternoon. Take in a round of golf or a tennis match at nearby country clubs. Make a quick jaunt to Lincoln Road or Bal Harbour Shops for designer creations. Cap off the evening at one of the fine dining destinations in the area or attend a concert at the nearby New World Symphony.





DEVELOPMENT TEAM

A masterful vision made real

L' Atelier is the collaborative result of a highly experienced team of experts. This one-of-a-kind residence, with its artful details, is assembled from some of the most respected names in real estate, design, and architecture.

Exceptional Residence. Exceptional Team.



LUIS REVUELTA, ARCHITECT

Founded with a commitment to provide quality design balanced with sustainable, economically feasible solutions, Revuelta Architecture International has been the cornerstone of success behind many of the top projects in South Florida, throughout the U.S., and in various international destinations. Their creativity and skill have earned them a reputation for designing landmark residential, commercial, hospitality, and mixed-use projects that are as functionally sound as they are aesthetically pleasing. In addition to new, revolutionary ideas, Revuelta also excels at preservation and rehabilitation of historically significant structures, green building, and a willingness to pursue architectural concepts and details to their highest possible level.



HOLLY HUNT INTERIORS

Known for a look that is consistently at the forefront of style and quality, The HOLLY HUNT brand has become the premier design and distribution entity for high-end interior furnishings in the country. Holly herself has often been credited with raising the bar in interior design showrooms, due to her tireless attention to detail and visionary artistry. As an arbiter of refined taste, her eye for what is now and what's next has led to international acclaim, and the success of the HOLLY HUNT company as a designer and producer of a wide range of custom-made home furnishings products.



**ENZO ENEA,
LANDSCAPE
ARCHITECT**

With a background that includes industrial design as well as landscape architecture and a design perspective drawn from global inspiration in London, Brazil, Hawaii, and beyond, the award-winning design of Enea is treasured for its refinement and visual appeal. A hallmark of the firm's projects include a seamless fusion of outdoor and indoor spaces, the creative intertwining of the soul of a property with its surroundings, and an environment that inspires all who interact with the space.

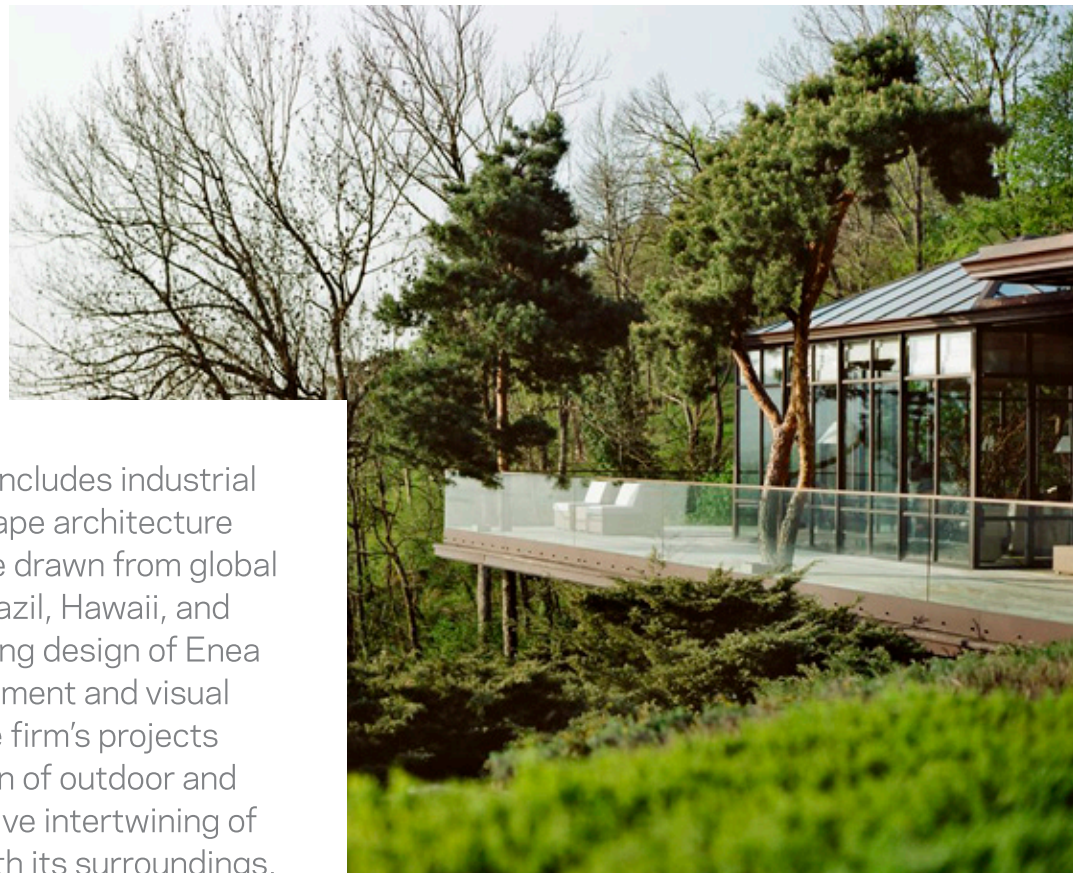

**SMG MANAGEMENT
W CAPITAL GROUP,
DEVELOPERS**



SMG Management was created out of the partnership between Shamrock Holdings (the investment vehicle of the Roy E. Disney family) and its business partners, Stanley Gold (Chairman of Shamrock) and Meir Srebernik (former CEO of Dankner Investments).

The innovative minds that make up this unique firm are the same behind two beautiful new residential developments: Palau Sunset Harbour, located in the Sunset Harbour neighborhood of South Beach and Peloro Miami Beach located on the Beach's Intracoastal Waterway. Partnering with SMG Management, is W Capital Group – a privately held South Florida real estate investment and development firm specializing in residential properties. Led by Yair Wolff, the firm has been focusing on the South Florida market since 2008. At present, W Capital Group is developing Ocean Drive Townhomes, a luxury residential project in the heart of Miami's South of Fifth Neighborhood.